

## **SOUND**

### **FOH (Open Venue using Main Stage):**

2x RCF SUB8004-AS (1250W RMS/Sub)  
2x RCF Touring and Theatre TT22a ii (1100W RMS/Side)  
2x QSC K8 Centre Fills (if requested)  
2x QSC K8 L+R Rake Delay Fills (controlled via separate matrix)

### **FOH (Acoustic Black Box Configuration):**

2x RCF SUB8004-AS (1250W RMS/Sub)  
2x RCF Touring and Theatre TT22a ii (1100W RMS/Side)

### **Monitoring:**

2x Martin Audio LE350a Passive Wedges  
4x EV112 Passive Wedges

\*6 way Monitor Mix controlled via FOH Console

### **Mixer:**

#### **Allen & Heath QU-24 Digital Console**

24 Mono Inputs (via AR2412 Digital Stagebox)  
3 Local Stereo Inputs  
4 Assignable Internal FX Engines (A&H iLive FX Library)  
4 Mute Groups  
Trim, polarity, HPF, gate, 4-band PEQ, compressor and delay on all Inputs  
1/3 octave GEQ, compressor and delay on Main LR and Mono Aux Mix outputs  
4-band PEQ, compressor and delay on Stereo Mix outputs  
Qu-Pad iPad Controller (enables remote mixing from preferred position)

Due to seating configuration and space limitations in the Music Hall we have three, Fixed Mixing and LX Control positions depending upon the configuration of the seating/rake. \*Seating configuration upon discretion of the Witham Management Team. \*Please see Floor Plans\*

1. When using the Raked Seating, Mix Position A is used. This is at the back of the Music Hall on a mezzanine floor which is at a height of 3.2m. Position A is in the same room as the audience and access is via the Raked Seating steps.
2. When we are in a cabaret seating configuration, we use Mix Position B or C. These are at floor level and we can provide a 24 channel analogue patch at Mix Position B **ONLY**. Visiting companies are welcome to use mix Position B or C, however companies will need to provide at least a **25m** Multicore to reach the side of the Acoustic Wall Stage, or a **40m** to reach the side of the Main Stage if they are using a toured Mixing Desk at Mix position C.

### **Mics**

5x Shure SM58  
2x Sennheiser e845  
4x SE Electronics sE1a Pencil Condenser  
5x Audix i5  
1x Sennheiser e602ii  
1x Sennheiser e604  
(Usual Drum Kit Mic Config: Mono sE1a OH, e602 Kick, e604 Floor, Audix i5 Snare)  
(2x additional Sennheiser e604 Tom Clip-ons can be requested for a £10 hire fee)

### **4x Sennheiser EM 100 G3-1G8 Receivers:**

2x Sennheiser EW100 Wireless Mic  
2x Sennheiser SK100 Lapel Mic

\*It is the responsibility of the Visiting Company or Performer to ensure that all radio equipment, except that provided by the venue, such as radio microphones and two-way radios are properly licensed. A copy of all applicable radio licenses should be available. The venue will refuse the use of radio equipment that cannot be shown to be licensed, or license free. For information on licensing please contact JFMG: [www.jfmg.co.uk](http://www.jfmg.co.uk)  
4th Floor, UK House, 2 Great Titchfield Street, London, W1W 8BB, 020 7299 8660\*

### **DI Boxes**

6x Klark Teknik DN100 Active Mono Boxes  
1x Klark Teknik DN200 Active Stereo Box  
2x DBX dB-10

### **Playback**

Numark MP103USB CD Player

## **Cabling & Power Distro**

24/6 Stage Right Signal Patch.

24 Channel 15m Analogue Multicore

AR2412 Digital Stagebox (for use with in-house Digital desk and any toured A&H QU/GL desk)

6x 10m XLR

20x 6m XLR

6x 2.5m XLR

4x 1.5m XLR

4x 3m TS JACK

6x 15m Speakon for Monitors

+ other various lengths of mixed cable.

Various lengths of 1, 2 & 4 Gang 13a Power Distro

Multiple 16A Hot Power Ceeform outlets are available if required on centre of LX bars

## **Other**

20x Various K&M Boom Mic Stands

John Broadwood Boudoir Grand Piano (£60 tuning charge to an external promoter).

## **LX**

Lantern Stock:

4x Selecon HUI Flood

2x ETC Source 4 JR 26°

12x ETC Source 4 JR Zoom 25°-50°

16x Selecon Acclaim Fresnels

2x Selecon Acclaim 24°-44°

2x Strand Polaris 1k Fresnel

8x PAR 56

6x PAR 64

4x PAR 64 Short-nose Floor-can

Dimming:

48 Chan Zero 88 Chilli Pro

24 Chan Transention Rack Mounted Packs

2x Hot Feed 16A Ceeform outlets are available + DMX Patching on each bar/truss for Moving lights etc.

Please see Standard Rigging Configuration Below. Other LX rigging can be arranged but we must have at least 4 weeks notice. (Please note that to an external promoter, specific lighting setups may incur an additional £120 rigging fee for up to a 6 hour re-configuration.)

## **AV**

Christie DWU775E HD Projector

Sapphire 200" Electric Screen

5.1 Surround Sound

Dennon DBT-3313UD Universal Audio/Video Player (Bluray)

## **OTHER**

1x JM Lectern (Model 9420)

4x RAT Professional "opera" Music Stands with LED Light

## STANDARD LIGHTING RIG

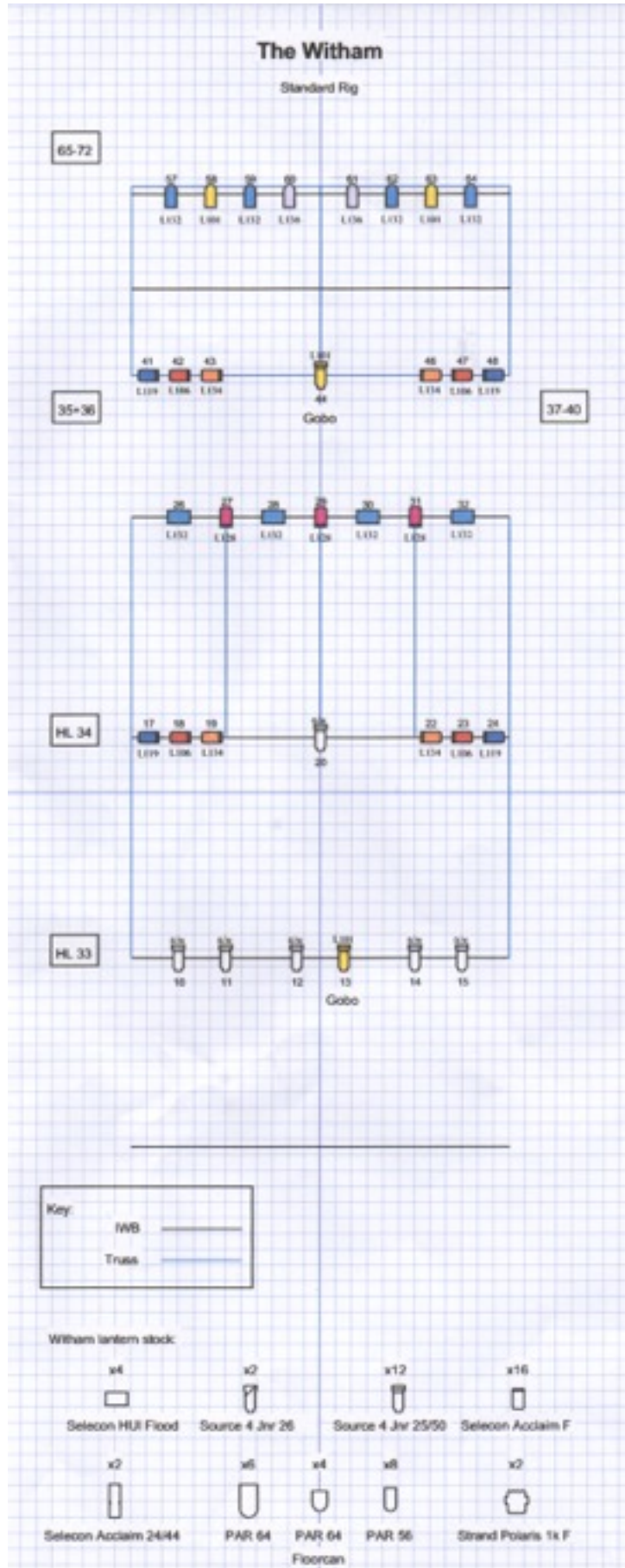

## Floor Plan 1: Music Hall with Raked Seating

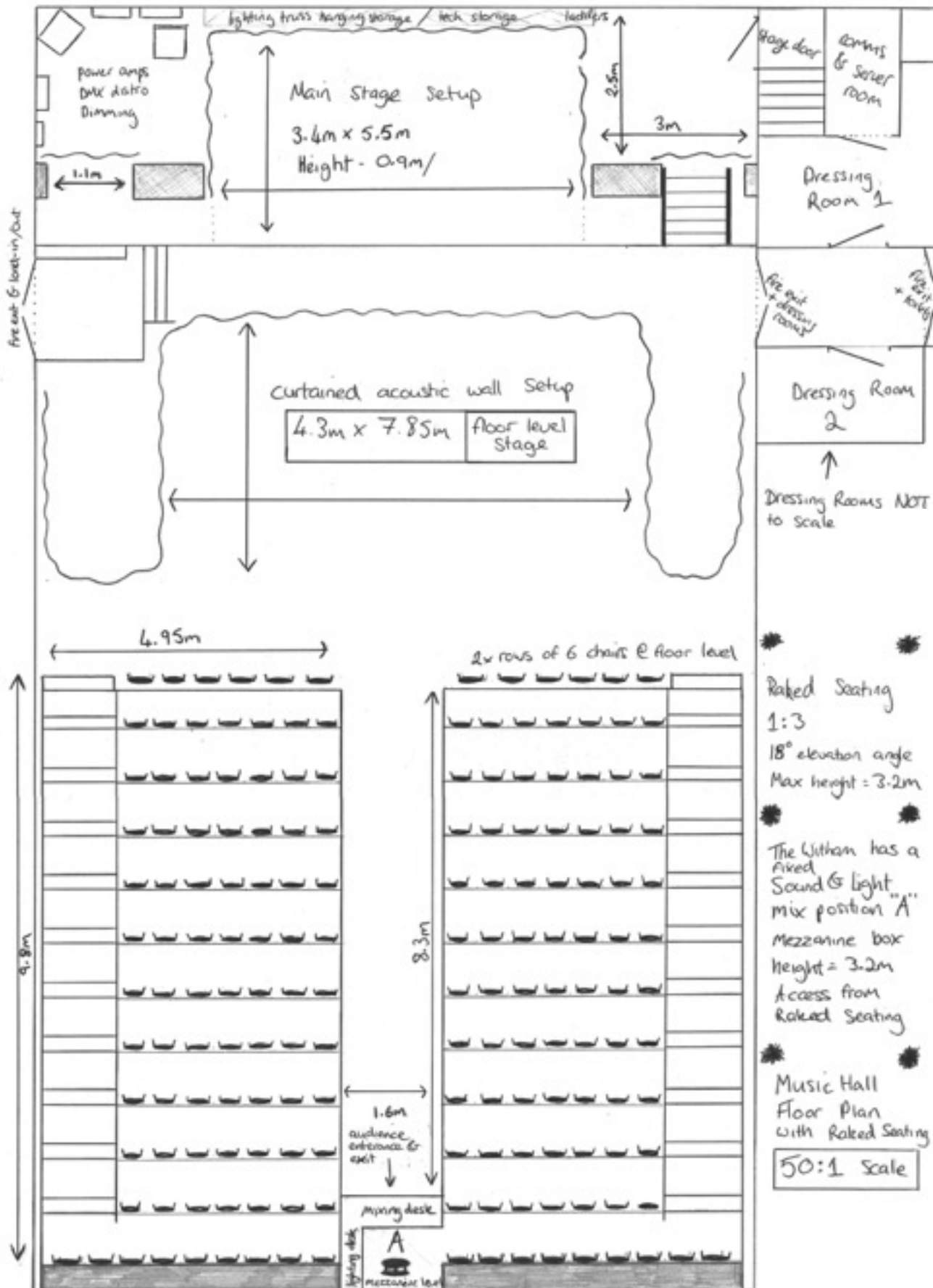

## Floor Plan 2: Music Hall Cabaret Floor Setup

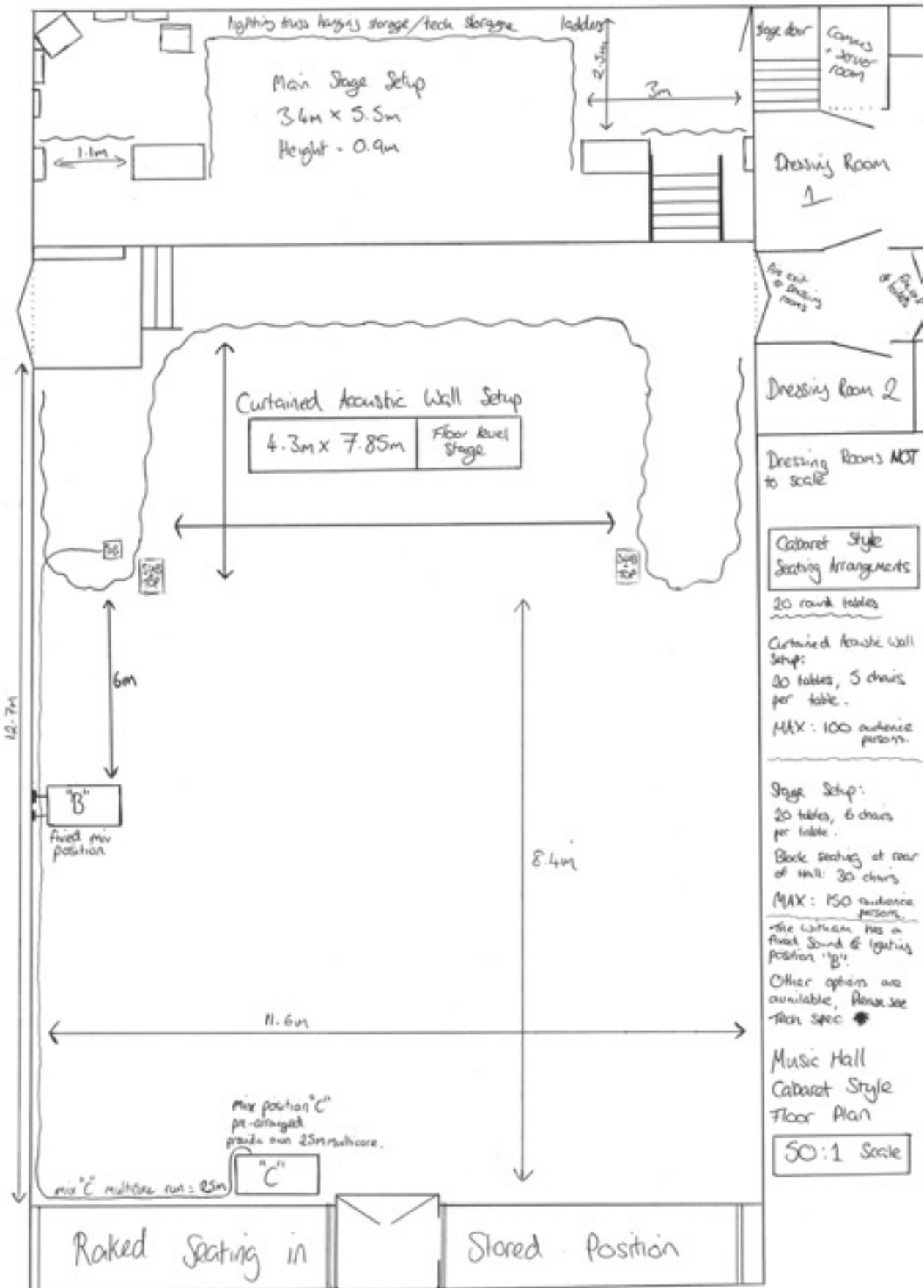

## **Notes**

### **Seating Capacity:**

1. Main Stage Setup with Raked Seating - 250
2. Curtained Acoustic Wall Setup with Raked Seating - 170
3. Main Stage Setup Cabaret Style - 150:  
20 Round Tables - 6 Chairs Per Table + 30 Seats at Rear of Hall.
4. Curtained Acoustic Wall Cabaret Style - 100:  
20 Round Tables - 5 Chairs Per Table

The Witham is situated in a small market town, The venue was recently refurbished and re-opened in 2013. The original building was built in 1860 and the £3.2m restoration of the Grade II listed building won the Building Conservation Award at the Royal Institution of Chartered Surveyors (RICS) North East Renaissance Awards.

Please note that the above tech spec is our suggested spec for the size of the small venue. Due to storage, stage space and load-in limitations, We would advise any companies that are wanting to bring their own Sound/Lighting rigs to visit the venue in plentiful time before booking the venue.

For more information, or to book a visit to assess the venue space. Please contact the Technical and Facilities Manager;

**[tom.stanier@thewitham.org.uk](mailto:tom.stanier@thewitham.org.uk)**